

CERRON Commercial Properties, LLC
21476 Grenada Avenue
Lakeville, MN 55044
www.CERRON.com

■ PROPERTY HIGHLIGHTS

- Warehouse Bays
- One Bay Available:
6,250 SF individual
warehouse bay
- Lease Rate:
\$4.50/SF Net + CAM/tax
\$1.35/SF = \$3,050 Total
Monthly Rent
- Zoned I-1
- One dock door
- Located on Highway 3
with easy access to major
highways

WAREHOUSE LEASE SPACE

21130 CHIPPENDALE AVE, FARMINGTON, MN 55024

FOR LEASE | WAREHOUSE

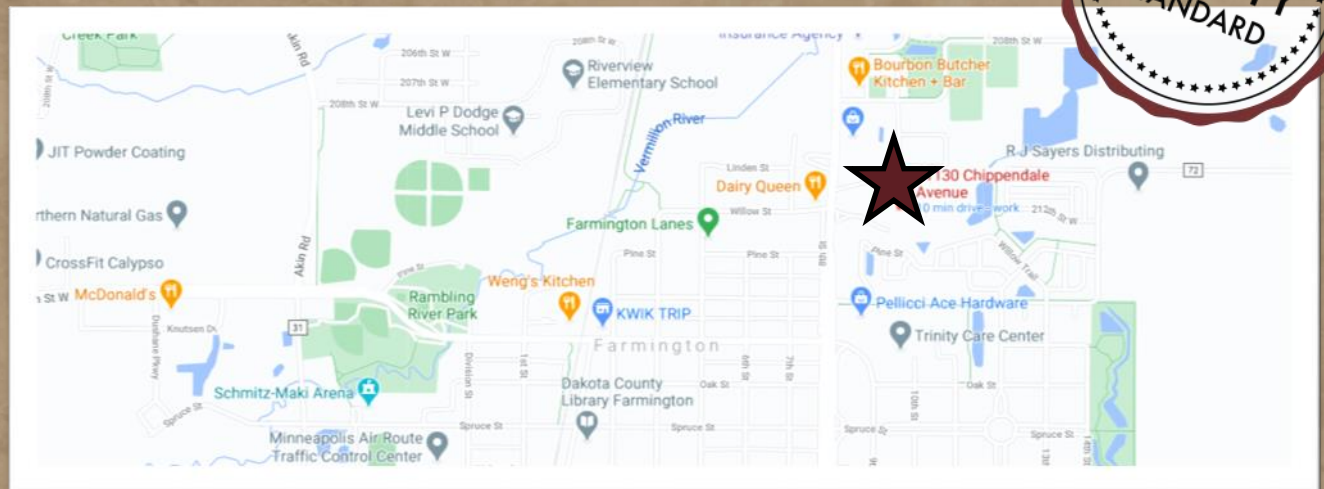

DISCLAIMER: The information contained herein is deemed reliable but is not guaranteed. We have not verified its accuracy nor do we make any warranty or representation about it. You and your tax and legal advisors should conduct your own investigation of the property and transaction.



For more information,
please contact:
Bruce Rydeen
952.469.9444
brucer@cerron.com

FLOOR PLAN

WAREHOUSE LEASE SPACE

21130 CHIPPENDALE AVE, FARMINGTON, MN 55024

WAREHOUSE BAY
 6,250 SF Bay Available
 HEATED
 SHARED DOCK DOOR

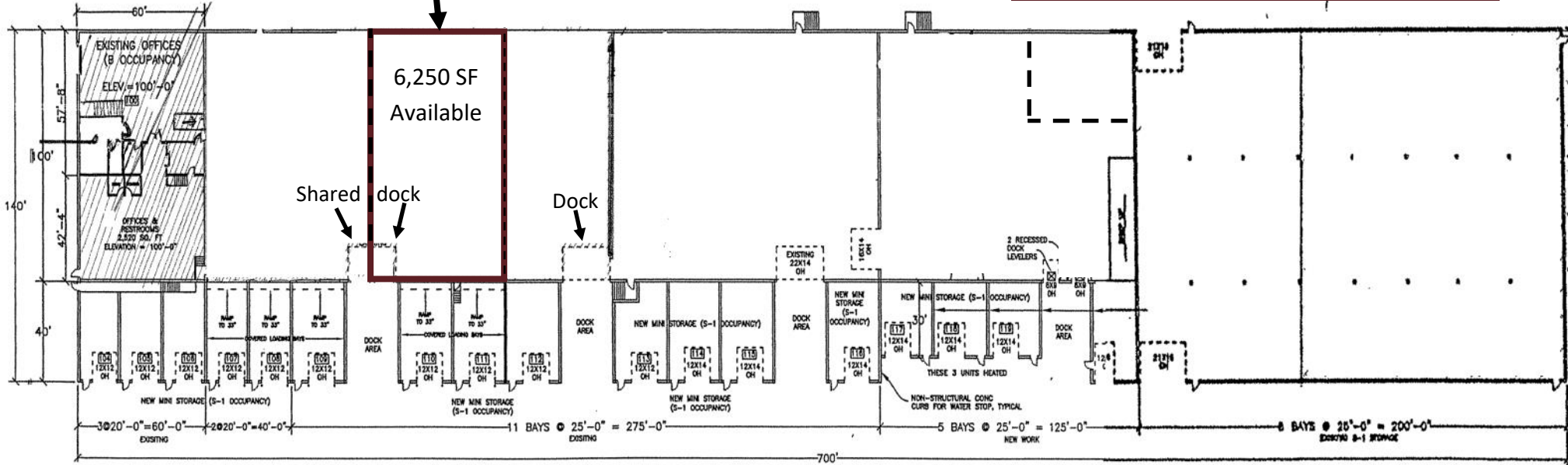

DISCLAIMER: The information contained herein is deemed reliable but is not guaranteed. We have not verified its accuracy nor do we make any warranty or representation about it. You and your tax and legal advisors should conduct your own investigation of the property and transaction.



For more information,
 please contact:
Bruce Rydeen
952.469.9444
 brucer@cerron.com